

# ***EMMO*** ***ZOOMI E-BIKE***

**OWNER'S MANUAL**



# Preface

## An Important Message From EMMO

Thank you for choosing EMMO. Congratulations on your purchasing of a new ZOOMI.

This document is intended as a short introduction to your new e-bike. It contains essential safety, performance and service information. Please read and understand this manual fully before assembling and riding your bike. Be sure to watch the official Emmo ZOOMI assembly video available at <https://emmo.ca/pages/e-bike-assembly-guide>.

Additional information about your bike can be found on our website at [www.emmo.ca](http://www.emmo.ca).

Be sure to check all hardware for correct torque during assembly.

## Illustrations

Illustrations shown in this document may differ in detail from the exact configuration on your particular e-bike model. The illustrations are a general reference for instruction and description purposes only.

## Service & Support

If you have questions after reading this manual and watching the assembly video, please feel free to contact us.

**E-mail:** [service@emmo.ca](mailto:service@emmo.ca)

**Toll Free:** 1-888-217-1217

**Find Emmo dealers near you:** <https://emmo.ca/pages/locations>

# Contents

<b>About This Manual</b> .....	<b>5</b>
<b>About EMMO</b> .....	<b>6</b>
<b>Rules and Regulations</b> .....	<b>7</b>
<b>Safety Disclaimer</b> .....	<b>11</b>
<b>Description</b> .....	<b>15</b>
Schematic Diagram .....	15
Side View .....	15
Handlebar Attachments .....	16
Speedometer .....	19
<b>Operation Guide</b> .....	<b>20</b>
How to Turn on the Bike .....	20
Key Ignition/Steering Lock .....	20
Seat .....	23
Remote .....	25
Circuit Breaker .....	26

Right Switches.....	27
Left Switches.....	28
Throttle.....	29
Speed Governor.....	30
Storage.....	31
Tail box.....	31
Multimedia Controls.....	32
Charger.....	34
Lead Acid Charger.....	34
Lithium Charger.....	39
Battery.....	48
Battery Safety Precautions.....	48
Disposal.....	49
Storage & Maintenance.....	50
Stand.....	51
Side Kickstand.....	51
Centre Stand.....	52

Pedal.....	55
Lights.....	57
Tail light & Brake Light.....	57
Signal Lights .....	58
Cleaning / Lubricating the Chain.....	59
Tire Pressure .....	60
Serial Number.....	62
Frame Number.....	62
Motor Number.....	63
Checking List Before Riding .....	64
<b>Warranty Policy .....</b>	<b>65</b>
<b>Leave Us a Review .....</b>	<b>68</b>
<b>Contact Us.....</b>	<b>69</b>

# About This Manual

This document is intended as a short introduction to your new e-bike. It contains important safety, performance and service information. Read and understand it along with the information provided during the on-delivery instructions before using the product. Pay special attention to the safety messages as shown here, and keep the manual handy for future reference.



**WARNING:** Warning about a situation that can cause death, serious physical injury and or heavy material damage if one does not obey the safety instructions.



**DANGER:** Danger statement indicates a hazardous situation that, if not avoided, has a very high risk of death, serious injury, or property damage.



**CAUTION:** Caution statement indicates a hazardous situation that, if not avoided, could result in minor or moderate injury or property damage.



**NOTICE:** Notice is important information that can help you avoid bike/property damage or extend the life of parts and the bike.

# About EMMO

Emmo is a proud Canadian company based in Toronto, Ontario. As the leading brand of electric bikes, Emmo has provided over 500,000 people with environmentally-friendly transportation throughout North America. We believe that electric mobility for everyone is a big step in moving towards a zero-emission future.

Since 2009, Emmo has offered a large selection of electric mobility options for commuting and recreation. With our diversity of products, we create high-quality options to accommodate everyone's needs with an emphasis on reducing their carbon footprint. The past decade has proven that Emmo e-bikes are not only a sustainable method of transportation, but that they also push the limits of conventional bikes –to take you further, with less effort and more fun.

Driven by our vision of inspiring more people to lead a greener lifestyle, Emmo strives to give our riders' the best experience possible. Our in-house research and development spans two continents. Our e-bikes are designed in North America and undergo rigorous testing at our state-of-the-art facilities. Throughout this process, every facet of this complex supply chain is vigorously scrutinized to ensure the end product arrives in flawless condition at our four distribution centers in North America. We continue to be at the forefront of the e-bike industry. With over 100 retailers, Emmo is never too far away.

For over 13 years, our strong commitment to design and innovation has resulted in every Emmo product encompassing the latest technology. Our e-bikes exclusively use programmable sine-wave BLDC controllers, allowing higher performance, longer range and enhanced reliability in all conditions. Backed by our comprehensive warranty, we ensure riders are confident in the purchase of their Emmo.

Emmo believes that a greener future is not only possible, it's necessary, and we want to do our part to build greener communities by making e-bikes more accessible.

# Rules and Regulations

According to **Canada's Motor Vehicle Safety Regulations ( MVSR )**. A qualified e-bike (defined as Power Assist Bicycle) must meet the following requirements:

- **The e-bike must have operable pedals**
- **Upper wattage limit for the motor is 500W**
- **Maximum speed of an e-bike is 32km/h.**

Other requirements include a permanently affixed compliance label from the manufacturer stating that the vehicle is a power-assisted bicycle under statutory requirements in force at the time of manufacture. Currently, there is no license, no insurance, and no vehicle registration required to operate a qualified e-bike according to federal legislation. E-Bike riders share the same rights and responsibilities as other road users.

However, provinces and local municipalities have the power to restrict the use of e-bikes. Most provinces require the rider to wear a helmet. Some provinces have special requirements with regard to the age limit to operate an e-bike, the type of helmet required, even the number of wheels and wheel size. In Ontario, typically, e-bikes are generally treated the same as regular bicycles. According to the Ministry of Transportation of Ontario (MTO), the age limit to operate an e-bike is 16 years old and above; the maximum weight of the bike is 120 kilograms (265 pounds); the bike must have a brake distance of less than 9 meters; Any modifications made to the bike's motor to create speeds greater than 32km/h are prohibited.

As the rules and regulations are subject to changes in different provinces and municipalities. Please check your **municipal** bylaw and see where you stand.

# Rules and Regulations

## Useful links:

E-Bike Regulations in Ontario:

<https://www.ontario.ca/page/riding-e-bike>

E-Bike Regulations in British Columbia:

[https://www.bclaws.gov.bc.ca/civix/document/id/complete/statreg/151\\_2002](https://www.bclaws.gov.bc.ca/civix/document/id/complete/statreg/151_2002)

E-Bike Regulations in Alberta:

<http://www.transportation.alberta.ca/content/doctype45/production/mopedpowerbikes.pdf>

E-Bike Regulations in Manitoba:

<https://web2.gov.mb.ca/laws/statutes/ccsm/h060e.php>

E-Bike Regulations in Saskatchewan:

[https://www.sgi.sk.ca/motorcycle/-/knowledge\\_base/motorcycle-handbook/power-assisted-bicycles1](https://www.sgi.sk.ca/motorcycle/-/knowledge_base/motorcycle-handbook/power-assisted-bicycles1)

E-Bike Regulations in Quebec:

<https://saaq.gouv.qc.ca/en/road-safety/modes-transportation/electric-bike>

E-Bike Regulations in New Brunswick:

[https://www2.gnb.ca/content/gnb/en/services/services\\_renderer.200814.Motor\\_Vehicle\\_Registration.html](https://www2.gnb.ca/content/gnb/en/services/services_renderer.200814.Motor_Vehicle_Registration.html)

E-Bike Regulations in Nova Scotia:

<https://novascotia.ca/just/regulations/regs/mv18786.htm>

E-Bike Regulations in Prince Edward Island:

<https://www.princeedwardisland.ca/en/information/transportation-and-infrastructure/power-assisted-bicycles>

E-Bike Regulations in Newfoundland and Labrador:

<https://www.assembly.nl.ca/legislation/sr/annualstatutes/RSN1990/H03.c90.htm>

### **Know and obey all relevant local laws**

It is your responsibility to research and understand relevant laws where you ride your bike. Such laws may cover required helmets and safety gear, required lights and reflectors, required hand signals, where you can legally ride a bike (bikes and ebikes may have different restrictions), how fast you can go, what (if any) cargo or passengers you can carry, rider age, and more. Before using public transportation—buses, trains, etc.—to transport your e-bike, check with the relevant transportation authority for any rules governing weight limits, tire widths, lithium-ion batteries, or any other rules that might pertain to e-bikes. When you ride on the road, assume you must, at minimum, follow all of the rules that cars must follow. For additional information regarding traffic and vehicle laws, contact the road traffic authority in your area.

The product(s) comply with federal regulations for this product category in Canada and with applicable provincial

regulations in the region of sale at the time of purchase. In jurisdictions where the product(s) may NOT be compliant, the buyer acknowledges this possibility and accepts full responsibility for their use. The buyer is solely responsible for understanding and complying with all applicable laws, regulations, and bylaws related to the operation and use of the product(s) in their local area. If the product(s) are capable of going faster than the applicable legal speed limit, the seller is NOT responsible for the speed at which the buyer operates the product(s). Any future changes to legislation or regulatory classification that affect where or how the product(s) may be used are outside the control of the seller and shall NOT constitute valid grounds for return, refund, or compensation. Such changes do NOT imply any defect or misrepresentation of the product(s) at the time of sale.

# Safety Disclaimer

This manual contains important safety, performance, and service information. Read and understand it along with the information provided during the on-delivery instructions before using the product, and keep it for reference. Ensure that you comprehend all instructions and safety NOTes/warnings.

**Definition:** In this manual, the term “Vehicle” refers collectively to any bike, ebike, etrike, or similar vehicle sold or authorized by EMMO.

## General Responsibility

- By choosing to ride a Vehicle, you assume full responsibility for all risks, including falls, collisions, equipment failure, and road or traffic hazards.
- Riders are responsible for following local laws and bylaws, practicing safe riding, and maintaining the Vehicle properly.
- Safe use depends on responsible riding, regular inspections, and timely replacement of worn components.



### **WARNING: Fit & Capability**

- Ensure the Vehicle fits you properly before riding; incorrect sizing may cause loss of control.
- Riders must have sufficient physical condition, reaction time, and mental capability to handle traffic and emergencies. If you have medical conditions (including impairments or seizure disorders), consult your physician before riding.
- Before the first ride, practice braking and throttle control in a safe environment.

- If riding at night, familiarize yourself with the lights and signals and ensure they function properly.



## **WARNING: Installation & Maintenance**

- Improper installation, compatibility issues, or poor maintenance can cause serious injury or death.
- Secure all hardware (handlebar, grips, seat, pedals, etc.) before each ride.
- Have the Vehicle inspected by an authorized technician at least once every **6 months**.
- It is your full responsibility to ensure the Vehicle is in good working order at all times. Perform a pre-ride safety check **before every ride** (brakes, throttle, sensors, lights, and other key components).



## **WARNING: Battery & Charger Safety**

- The charger should only be used **indoors** in a cool, dry, ventilated area. Always position the charger on a **non-flammable surface** (e.g., concrete or brick), as it may generate heat during peak charging cycles.
- You must use a **dedicated 110V outlet** to charge your battery.
- Never cover the charger during charging or leave it unattended.
- Keep the battery and charger away from children, pets, water, and open flame.
- DO NOT submerge or allow the charger to be submerged in water or any liquid.
- **DO NOT** use the charger or battery if **any part of the cord, connector, or housing is frayed, cracked, exposed, or otherwise damaged**. Using damaged charging equipment or battery connectors can lead to malfunction, fire, or serious injury.

- Do NOT drop, strike, or expose them to shocks.
- Use only the charger supplied with the product or approved by EMMO.
- Disconnect promptly once fully charged. Do NOT charge for more than **12 hours**, whether the battery is full or not.
- If the battery is stored, check it at least **once a month**. If necessary, use the original charger to recharge the battery to about **75%**. Failure to perform regular checks or charging may result in malfunction or safety hazards.
- Disconnect immediately if there is a strange smell, smoke, or overheating.
- In the unlikely case of battery fire: **never use water**. Use sand to cover the fire and call emergency services.
- **Battery & Charger Rated Life Expectancy:** Lead-Acid Battery: 2 years (500 cycles); Lithium-Ion Battery: 4 years (1000 cycles); Charger: 4 years. All component lifespans assume normal use and proper maintenance. **Annual inspection & safety testing by an authorized technician are required to ensure safety.** Components that have exceeded their rated service life—or no longer provide expected performance—should be replaced to ensure safety and reliability. While proper care may extend usable life, this can NOT be guaranteed.



## **WARNING: Modifications & Non-Original Components**

- Do NOT use the Vehicle with trailers, stands, racks, or accessories that are not approved by EMMO. The use of non-original components or spare parts can jeopardize the safety of your Vehicle, void your warranty, and, in some cases, cause your Vehicle to not conform with applicable laws.
- Any unauthorized modifications (to the electrical system, controller, battery, or structural components) may compromise safety. **Such modifications void the warranty and are performed at the rider's sole risk.**



## **WARNING: Extreme Riding**

- Vehicles and components are NOT designed for extreme use such as jumps, stunts, or riding beyond your ability.
- Extreme riding may cause component failure, severe injury, or death.

### **Final Note:**

- Always ride responsibly, maintain the Vehicle regularly, and replace components when necessary.
- The rider assumes all risks associated with operating this Vehicle.
- For questions or concerns, contact your authorized EMMO dealer or EMMO Customer Support.

# Description

## 1. Schematic Diagram

### a. Side View

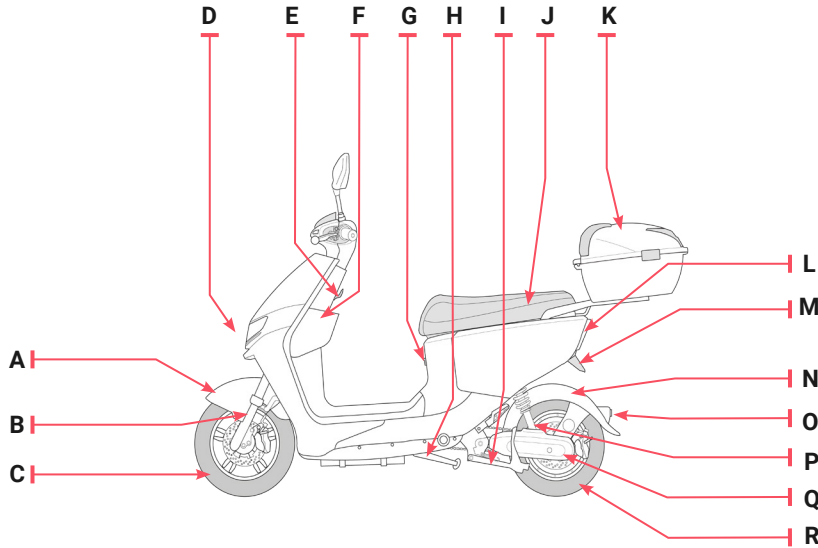

<b>A</b>	Front Fender
<b>B</b>	Front Shocks
<b>C</b>	Front Wheel
<b>D</b>	Headlight
<b>E</b>	Handbag Hook
<b>F</b>	Storage Compartment
<b>G</b>	Charging Port
<b>H</b>	Side Kickstand
<b>I</b>	Centre Stand
<b>J</b>	Seat Cushion
<b>K</b>	Tail Box
<b>L</b>	Tail Light
<b>M</b>	Licence Plate Holder
<b>N</b>	Rear Fender
<b>O</b>	Rear Reflector
<b>P</b>	Rear Shocks
<b>Q</b>	Chain Cover
<b>R</b>	Rear Wheel

# Description

## 1. Schematic Diagram

### b. Handlebar Attachments

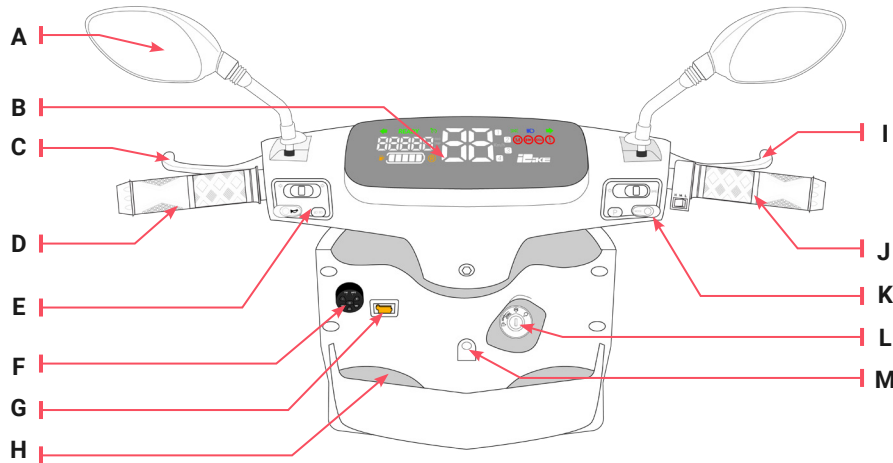

<b>A</b>	Rear View Mirrors
<b>B</b>	Dashboard
<b>C</b>	Left Brake Lever
<b>D</b>	Left Grip
<b>E</b>	Left Switch Housing
<b>F</b>	FM/MP3 Controls
<b>G</b>	USB Port
<b>H</b>	Storage Bin
<b>I</b>	Right Brake Lever
<b>J</b>	Throttle
<b>K</b>	Right Switch Housing
<b>L</b>	Ignition
<b>M</b>	Handbag Hook

# Description

## 1. Schematic Diagram

### c. Dashboard

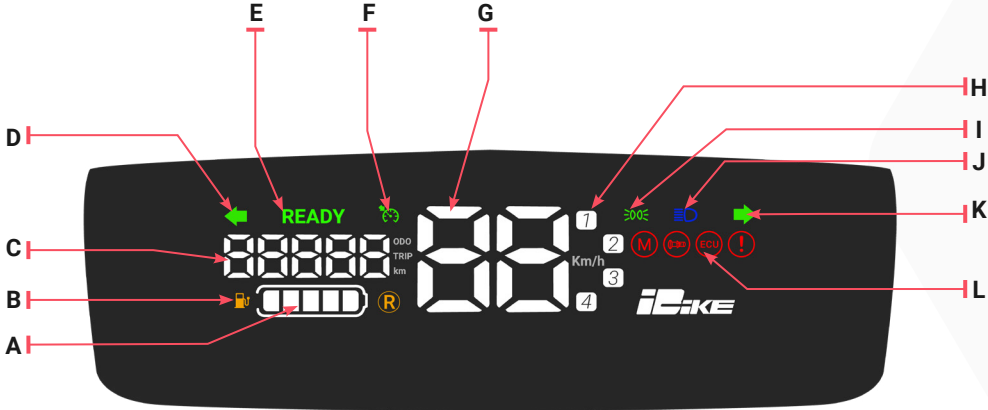

# Description

## 1. Schematic Diagram

### c. Dashboard



<b>A</b>	Battery Level Indicator	Indicates the current battery level. (Note: the accurate battery level is showed at full throttle instead of when the bike is still.)
<b>B</b>	Low Battery Warning Light	Lights up when the battery is low. charge your bike immediately.
<b>C</b>	Odometer	Total travel distance of the bike (cannot be reset).
<b>D</b>	Left Turning Signal	Flashes green when the turning signal switch is silde to the left. This arrow remains flashing until the turning signal is canceled.
<b>E</b>	Ride Ready Indicator	Lights up when the bike is ready for operation.
<b>F</b>	Cruise Control	Lights up when cruise control is activated.
<b>G</b>	Speedometer	Shows the real-time speed of the bike.
<b>H</b>	Speed Mode Indicator	Indicates the current gear/speed mode. (This function may not be available on some models)
<b>I</b>	Brake Light	Lights up when brake light is on.
<b>J</b>	High Beam Indicator	When the headlight high beam is on, this indicator illuminates blue and remains on until the high beam is turned off.
<b>K</b>	Right Turning Signal	Flashes green when the turning signal switch is silde to the right. This arrow remains flashing until the turning signal is canceled.
<b>L</b>	Warning Lights	Indicates working conditions/errors of the bike. Refer to <b>page 17</b> for details.

# Description

## 1. Schematic Diagram

### c. Speedometer

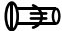
#### Warning Lights

	Motor Failure	Motor is out of order.
	Throttle Failure	Throttle is out of order.
<b>ECU</b>	Controller Failure	Controller is out of order.
	Brake Sensor Failure	Brake is applied (brake sensor is activated)/ Brake sensor is out of order.

# Operation Guide

## 1. How to Turn on the Bike

### a. Key Ignition/Steering Lock

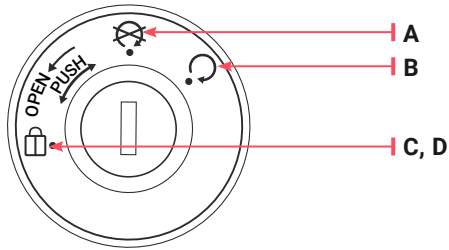

<b>A</b>	Power Off
<b>B</b>	Power On
<b>C</b>	Steering Lock (push)
<b>D</b>	Seat Lock

**This is a four-position switch that is located on the body:**

- Power Off
- Power On
- Steering Lock
- Seat Lock

# Operation Guide

## 1. How to Turn on the Bike

### a. Key Ignition/Steering Lock

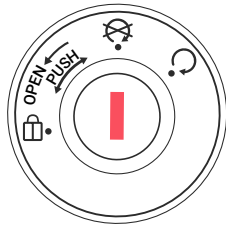

POWER OFF

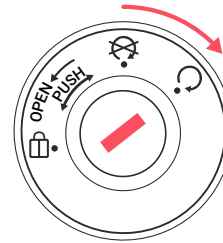

POWER ON

#### To turn on the bike:

- Insert the key.
- Follow the marking on the ignition, turn the key to the right to turn on the bike.

# Operation Guide

## 1. How to Turn on the Bike

### a. Key Ignition/Steering Lock

#### To lock the steering:

- Turn the ignition off.
- Turn the handlebar all the way to the left.
- Follow the marking on the ignition, push the key in and turn the key anti-clockwise.
- Remove the key.
- Ensure the steering is locked.

#### To unlock the steering:

- Insert the key
- Push the key in and turn it clockwise
- When unlocked, the steering can be turned freely.

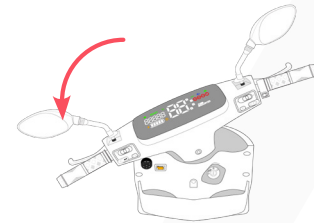

**TURN THE HANDLEBAR  
TO THE LEFT**

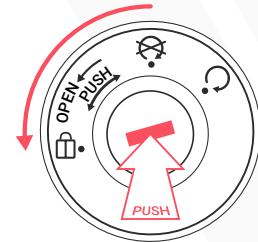

**LOCK THE  
STEERING**

# Operation Guide

## 1. How to Turn on the Bike

### b. Seat

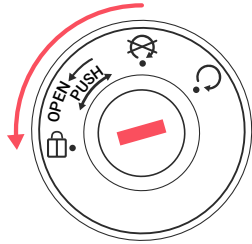

OPEN THE **SEAT**

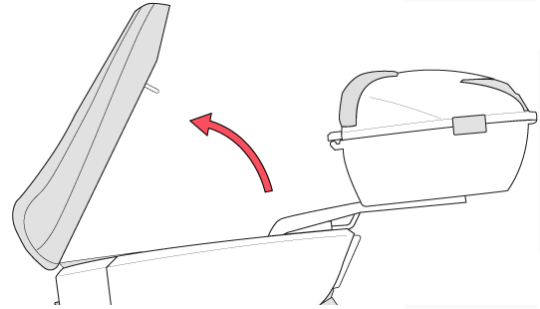

#### To Open the Seat:

- Insert the key to the ignition.
- Turn the key anti-clockwise (don't push the key).
- The seat will pop up when unlocked.

# Operation Guide

## 1. How to Turn on the Bike

### b. Seat

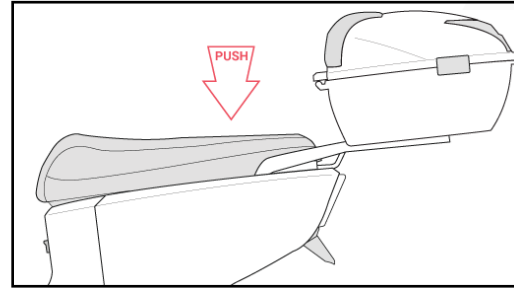
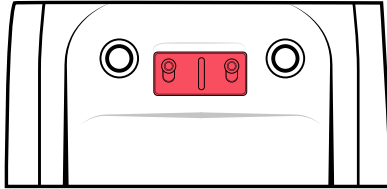

#### **To Lock the Seat:**

- On the bottom of the seat cushion, locate the seat lock hook (U shape bracket).
- Close the seat.
- Gently push the seat cushion down at the position of the seat lock hook.
- Make sure the seat is locked.

# Operation Guide

## 1. How to Turn on the Bike

### c. Remote

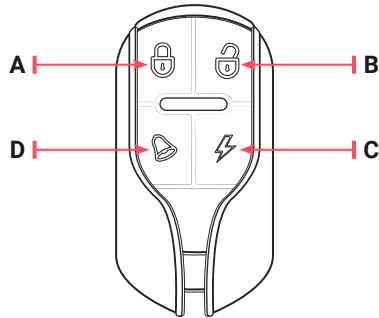

<b>A</b>	Lock Button	Press the button once to activate the anti-theft alarm system.
<b>B</b>	Unlock/Cancel Button	Press the button once to cancel the alarm or to turn off the bike if the bike is turned on with the remote.
<b>C</b>	Power Button	Press the power button <b>twice</b> to turn on the bike with the remote.
<b>D</b>	Panic Button	Press it once, the bike will sound 5 times.

### **!** NOTICE:

- By holding the unlock button, you can adjust the sensitivity of the alarm. 1 'beep' means least sensitive, while 5 'beep's means most sensitive.
- If the alarm system is on, cancel the alarm before you turn on the bike.

# Operation Guide

## 1. How to Turn on the Bike

### d. Circuit Breaker

**Located** in the storage compartment under the seat, the circuit breaker is the main switch of the bike. When it is turned off, the battery will be disconnected from the system and you will not be able to use the bike, nor will you be able to charge the bike.

#### Turn on the Circuit Breaker:

- Open the seat (Refer to [page 21](#))
- Locate the circuit breakers near the seat lock catch.
- Follow the marking on the circuit breakers to turn on/off the circuit breakers.
- Close the seat.

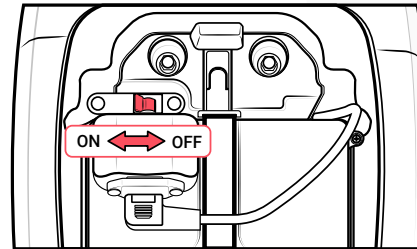

**WARNING:** The wires inserted into the circuit breaker could have high voltage output. **DO NOT** touch any bare wires. If you have any concern, contact your EMMO dealer for assistance.

# Operation Guide

## 2. Right Switches

The switches control the lights, signals, horn and etc..

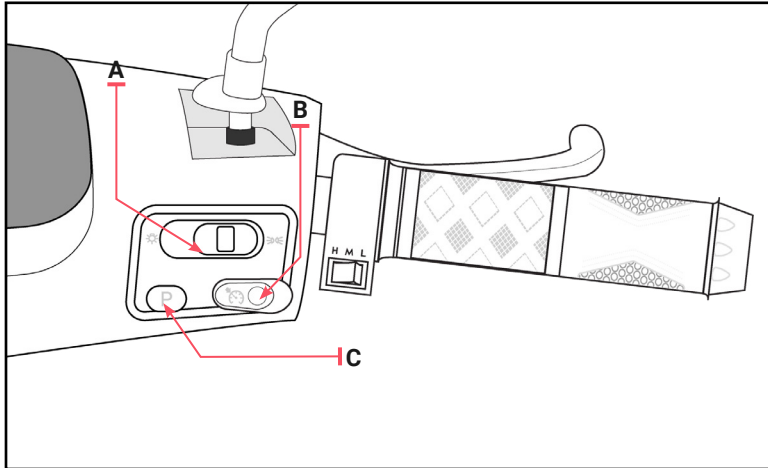



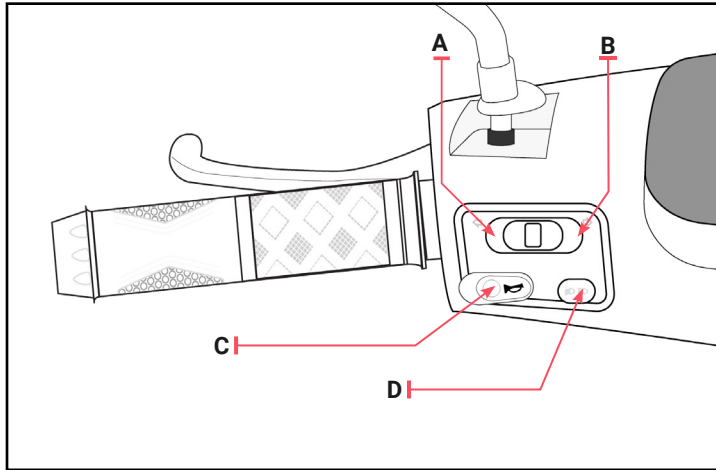

A	Lights	• (Off)	Slide the lever to toggle between different lighting modes.
		☞☞ (Daytime Running Light)	
		☀ (Headlight)	
B	Cruise Control	🕒	Press once to turn on cruise control at current speed. Press again to turn off.
C	Parking Brake	P	Press once to engage or disengage the parking brake.

# Operation Guide

## 3. Left Switches



A		Left Turning Signal	Slide the switch to the left to activate. Slide to the center to cancel.
B		Right Turning Signal	Slide the switch to the right to activate. Slide to the center to cancel.
C		Horn	Press the button to sound the horn.
D		High Beam & Low Beam	Press the button to toggle between high beam and low beam.

# Operation Guide

## 4. Throttle

The throttle controls the speed of the e-bike. As shown below, twist the throttle towards you to operate.

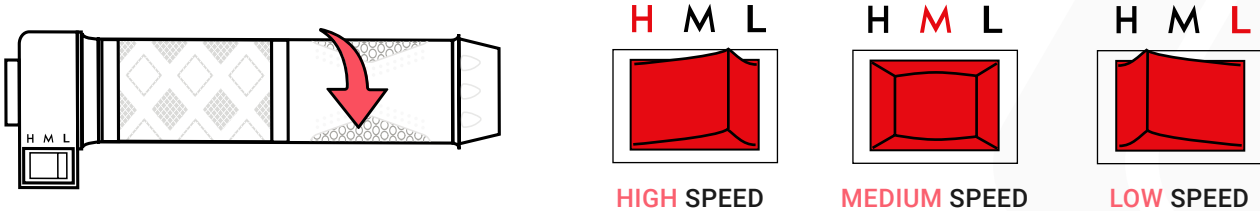

- Twist the throttle towards yourself to go.
- Use the speed mode Switch to toggle between the speed settings. (High/Mid/Low)



**WARNING: DO NOT** turn the throttle if you are not ready to ride.

# Operation Guide

## 5. Speed Governor

The speed governor restricts the maximum speed of the e-bike. By law, it is capping at 32km/h.



**WARNING:** Always follow your local laws and guidelines when riding the bike in public areas.

# Operation Guide

## 6. Storage

### a. Tail box

#### Unlock the tail box:

- Open the latches on both sides of the box.
- Insert the key to the lock, then turn the key counter-clockwise to unlock.

#### Lock the tail box:

- Keep the tail box lock at the unlock position, close the tail box.
- Turn the key clockwise to lock the tail box.
- Close the latches on both sides of the box.

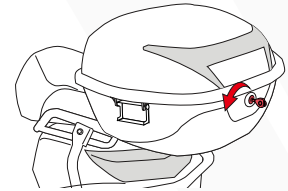
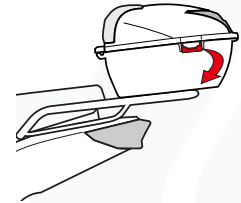

# Operation Guide

## 7. Multimedia Controls

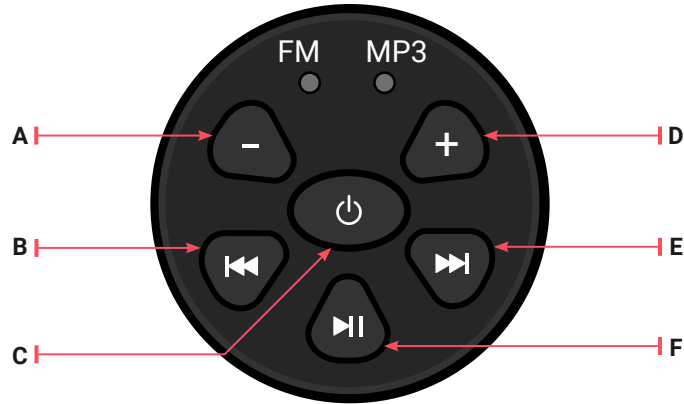

# Operation Guide

## 7. Multimedia Controls

<b>A</b>	Volume Down	Turn the volume down.
<b>B</b>	Previous	<b>MP3</b> - Press the button once to play the previous song in the list. <b>FM radio</b> - Press the button once to switch to previous channel in the list.
<b>C</b>	Power / Mode Switch	Press once to turn on the radio system. 1. The <b>MP3</b> mode is set by default. You can pair your bluetooth device with the built-in <b>MP3</b> player (named <b>Electric bike</b> ). Press the button again to switch to <b>FM radio</b> mode. 2. Press the button again to turn off the radio system.
<b>D</b>	Volume Up	Turn the volume up.
<b>E</b>	Next	<b>MP3</b> - Press the button once to play the next song in the list. <b>FM radio</b> - Press the button once to switch to next channel in the list. Hold the button to search for available channels (initialization).
<b>F</b>	Play / Pause	<b>MP3</b> - Press the button once to pause. Press again to continue to play. <b>FM radio</b> - Hold the button for 5 seconds to search for available channels. Once finished the system will stop at the first channel

# Operation Guide

## 8. Charger

### a. Lead Acid Charger

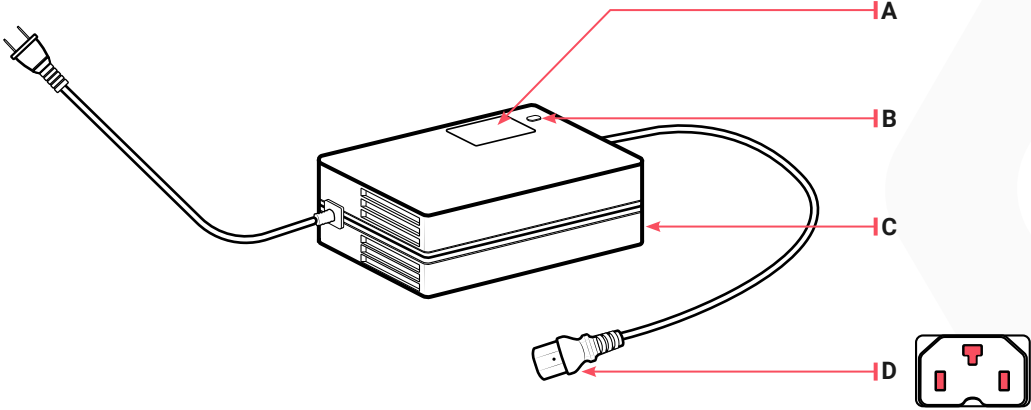

<b>A</b>	Front Label
<b>B</b>	Charging Indicator
<b>C</b>	Charger Specification Label
<b>D</b>	Charging Plug

# Operation Guide

## 8. Charger

### a. Lead Acid Charger

#### A. Front Label

The front label contains brief information of the voltage and capacity of the battery that the charger should be used for (more details are included in the specification label on the back of the charger).



- '72V' means the bike is 72V.
- '20Ah' means the battery capacity is 20 Amper hour.

# Operation Guide

## 8. Charger

### a. Lead Acid Charger

#### B. Charging Indicator

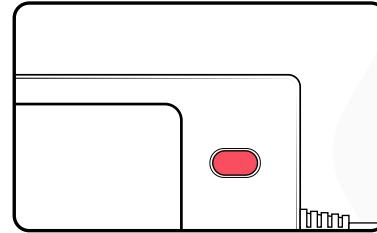
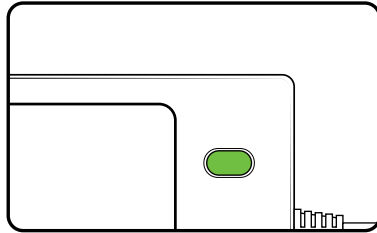

#### Charging Indicator Explanation:

- During normal charging, red light keeps on.
- The indicator will turn green when the battery is fully charged.

**!** **NOTICE:** If the charger gets warm during regular use, this is a normal response and is no cause for concern.

# Operation Guide

## 8. Charger

### a. Lead Acid Charger

#### C. Charger Specification Label

## XCH - 7220 CHARGER

Be Suitable For 72v20ah Lead Acid Battery  
Input: 110V AC 50/60HZ,2A  
Output: 88.0V DC --- 2.6-3.0A



### User Guide

1. First of all please check whether the battery is suitable for the charger .whether positive and negative could match or not. Otherwise, When you use the charger , please connect the charge r.
2. During charging, indicat or light is red, Whe n the battery is full, the indicat or light is green .
3. Charging finished, you must unplug the powe r, and then unplug the output plug .
4. Charging Time: 4 to 10 hours (depending on the capacity of battery).

### WARNING



1. There is high vottage power, dangerous! Unauthorized disassembly is forbidden and wet hand could not be t ouch with power plug. Otherwise, please dorft use it in the environment or moist, inflammable gas and explosive atmosphere.
2. Please don 't inser t any metal in to the charge r, and store in a dry warehouse, and keep fr om rain.
3. During charging, keep open or ventilation .
4. If the charging time is over 36 hours or it is unwatched, please shut ofe th power immediatly.
5. Avioid carrng the charger at all times, because violent vib rations will damage the charger .
6. If the charger is failed, please contact the supplier immediat y.
7. If the indicator light is still red, not green light, after 12 hours charging, please add supplementary acid for battery immediat y.

# Operation Guide

## 8. Charger

### a. Lead Acid Charger

#### D. Charging Plug

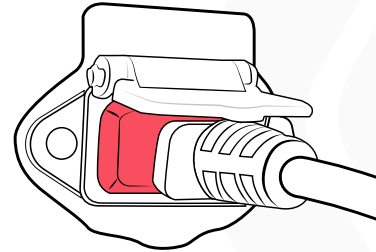
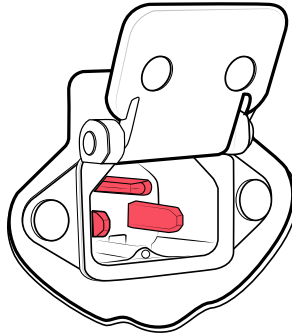
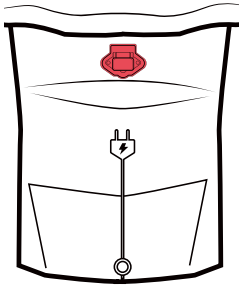

#### How to charge:

- The charging port is located beneath the seat. (Refer to ["side view", on page 13.](#))
- Open the charging port lid and plug in the charger.
- Plug the charger into a regular 110V wall outlet.

# Operation Guide

## 8. Charger

### b. Lithium Charger

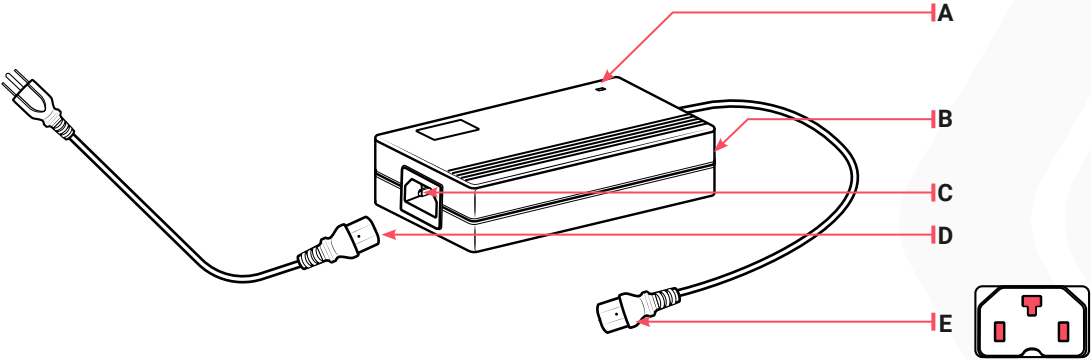

A	Charging Indicator
B	Charger Specification Label
C	Power Cord Socket
D	Power Cord
E	Charging Plug

# Operation Guide

## 8. Charger

### b. Lithium Charger

#### A. Charging Indicator

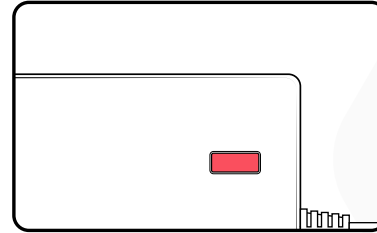
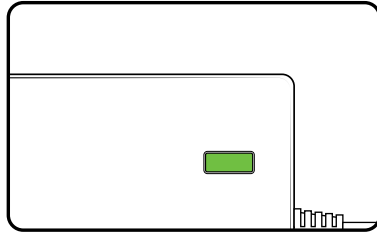

#### Charging Indicator Explanation:

- During normal charging, red light keeps on.
- The indicator will turn green when the battery is fully charged.

**!** **NOTICE:** If the charger gets warm during regular use, this is a normal response and is no cause for concern.

# Operation Guide

## 8. Charger

### b. Lithium Charger

#### B. Charger Specification Label

**Battery Charger**

**SANS**









MODEL: SSLC300V84  
INPUT: AC120V~3.0A  
60Hz  
OUTPUT: 84.0V  $\approx$  3.0



**CAUTION:** -Indoor use only, Charger only. 84V battery type rechargeable batteries. Other types of batteries may burst causing personal injury and damage. Risk of explosive. Read instructions 1 before using charger.

**ATTENTION**  
- l'intérieur seulement, la charge que 84V battery type de piles rechargeables. d'autres types de piles peut éclater et causer des dommages corporels. Risque d'explosion Lire les instructions 1 avant d'utiliser le chargeur  
0-30 °C

**DANGER:**  
Risk of electric shock. Do not touch uninsulated portion of output connector or uninsulated battery terminal

**DANGER:**  
Risque de chocs électriques. Ne pas toucher les parties non isolées du connecteur de sortie ou les bornes non isolées de l'accumulateur.

 **RED: CHARGING**  
 **GREEN: CHARGE-FULL OR DISCONNECT**

# Operation Guide

## 8. Charger

### b. Lithium Charger

#### C. Power Cord Socket

#### D. Power Cord

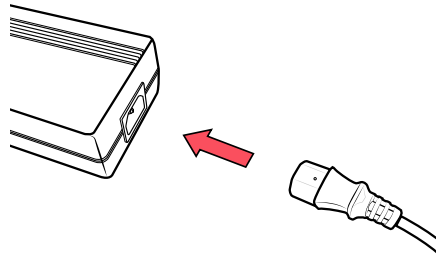

#### Connecting the charger:

- Plug the device connector **C** of the power cable into the device socket **D** on the charger.
- Before using the charger, plug the power cord C to the power cord socket D.



**WARNING: DO NOT** plug the power cord directly to the bike/battery. High voltage may damage the bike/battery and cause severe injury.

# Operation Guide

## 8. Charger

### b. Lithium Charger

#### E. Charging Plug

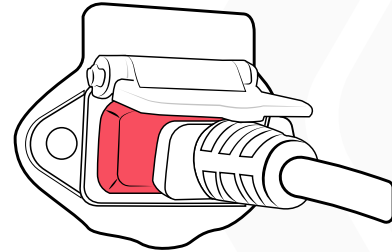
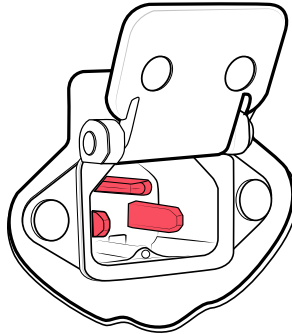
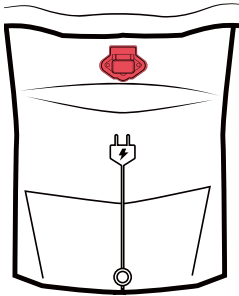

#### How to charge:

- The charging port is below the front of the seat. (Refer to ["side view", on page 10.](#))
- Open the charging port lid and plug in the charger.
- Plug the charger into a regular 110V wall outlet.

# Operation Guide

## 8. Charger

### b. Lithium Charger

How to Remove the Underseat Battery and Charge it off the Bike

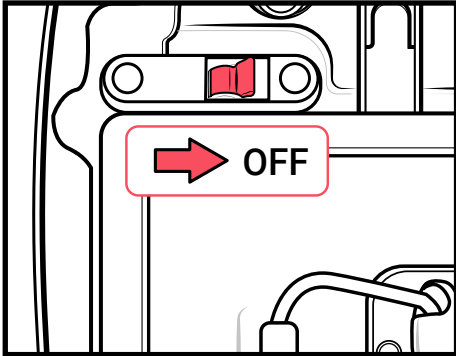

I. Open the seat, switch off the circuit breaker. (Red)

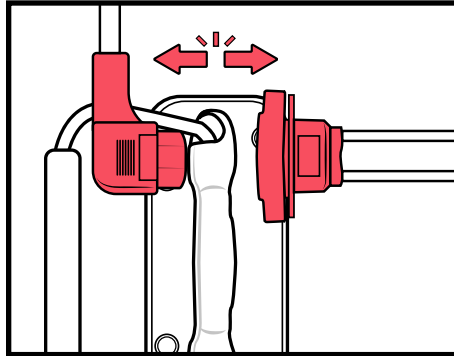

II. Disconnect the power plug.

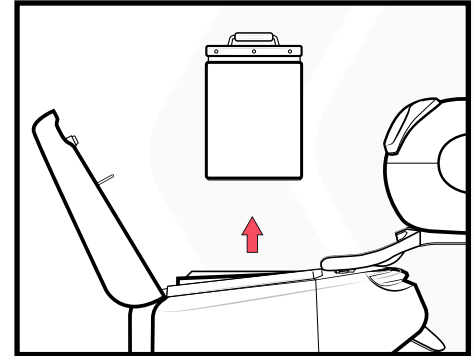

III. Take out the battery from the bike.

# Operation Guide

## 8. Charger

### b. Lithium Charger

How to Remove the Battery and Charge it off the Bike

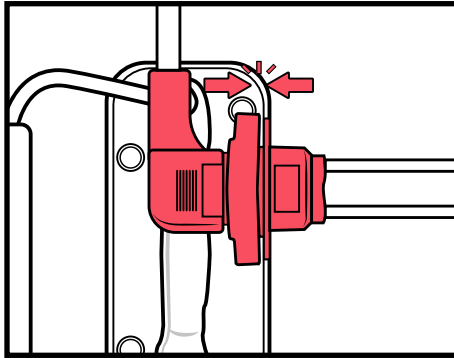

IV. Connect the charging plug with battery.

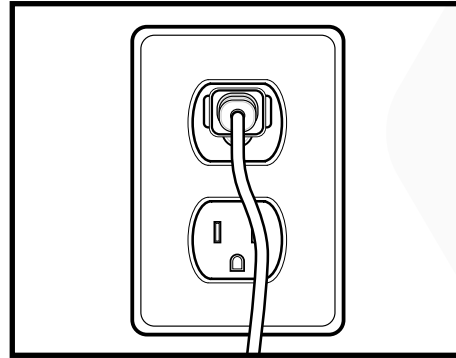

V. Connect the charger with power supply.

# Operation Guide

## 8. Charger

### c. Charging Precautions



#### **WARNING: Battery & Charger Safety**

- The charger should only be used **indoors** in a cool, dry, ventilated area. Always position the charger on a **non-flammable surface** (e.g., concrete or brick), as it may generate heat during peak charging cycles.
- You must use a dedicated **110V outlet** to charge your battery.
- Never cover the charger during charging or leave it unattended.
- Keep the battery and charger away from children, pets, water, and open flame.
- DO NOT submerge or allow the charger to be submerged in water or any liquid.
- **DO NOT** use the charger or battery if **any part of the cord, connector, or housing is frayed, cracked, exposed, or otherwise damaged**. Using damaged charging equipment or battery connectors can lead to malfunction, fire, or serious injury.
- Do NOT drop, strike, or expose them to shocks.
- Use only the charger supplied with the product or approved by EMMO.

- Disconnect promptly once fully charged. Do NOT charge for more than **12 hours**, whether the battery is full or not.
- If the battery is stored, check it at least **once a month**. If necessary, use the original charger to recharge the battery to about **75%**. Failure to perform regular checks or charging may result in malfunction or safety hazards.
- Disconnect immediately if there is a strange smell, smoke, or overheating.
- In the unlikely case of battery fire: **never use water**. Use sand to cover the fire and call emergency services.
- **Battery & Charger Rated Life Expectancy:** Lead-Acid Battery: 2 years (500 cycles); Lithium-Ion Battery: 4 years (1000 cycles); Charger: 4 years. All component lifespans assume normal use and proper maintenance. **Annual inspection & safety testing by an authorized technician are required to ensure safety.** Components that have exceeded their rated service life—or no longer provide expected performance—should be replaced to ensure safety and reliability. While proper care may extend usable life, this can NOT be guaranteed.

# Operation Guide

## 9. Battery

### a. Battery Safety Precautions



- Be sure to use the original/compatible battery (approved by EMMO). Using batteries from other brands may lead to severe accidents.
- Inspect the battery for any damage, leaking, overheating or smoking.
- Always charge between **0°C to 45°C**, charging outside of this range may cause permanent damage to battery.
- **DO NOT** lift the battery by its connectors or cables.
- **DO NOT** charge the battery for over 12 hours.
- **DO NOT** subject the battery to impact.
- **DO NOT** subject the battery to water.
- **DO NOT** subject the battery to heat or open fire.
- **DO NOT** open the battery pack by yourself. If you need any assistance, please contact your EMMO dealer.

[Refer to: Battery & Charger Safety for proper and safe use of battery & charger](#)

# Operation Guide

## 9. Battery

### b. Disposal



This product contains sealed lead acid batteries which must be disposed or recycled in an environmentally safe manner. Do not dispose of the batteries in your household trash. Do not dispose of the batteries in a fire, this could cause the batteries to leak or explode. The incineration, disposal in landfill and or placing sealed lead acid batteries with household trash is prohibited by law in most areas.

#### **NOTICE:**

- Used batteries must be treated as hazardous waste.
- Batteries must be disposed of in accordance with the the regulations set forth by your local government/organizations.
- In case of uncertainty, contact EMMO customer service department.

# Operation Guide

## 9. Battery

### c. Storage & Maintenance

- For storage, please disconnect the battery from the bike and charge the battery on a regular basis (at least once a month).
- Battery packs and chargers need to be stored in a clean, dry, ventilated place, avoid contact with corrosive material, and keep them away from heat and fire.
- Battery storage condition: Temperature:-20 - 35°C , humidity ≤ 65%RH.

# Operation Guide

## 10. Stand

### a. Side Kickstand

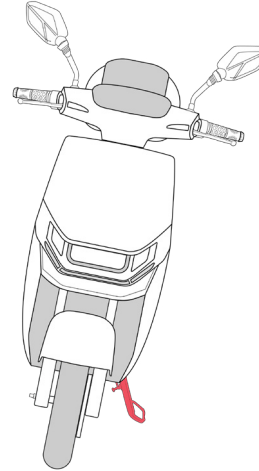
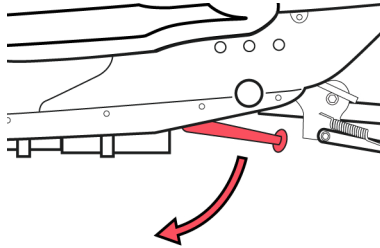

#### How to use the side kickstand:

- Kick the side stand down and gently lean the bike on the side kickstand.
- Make sure it is stable before you leave your bike.

**!** **NOTICE:** It is recommended to use the centre stand (next section) for long term storage.

# Operation Guide

## 10. Stand

### b. Centre Stand

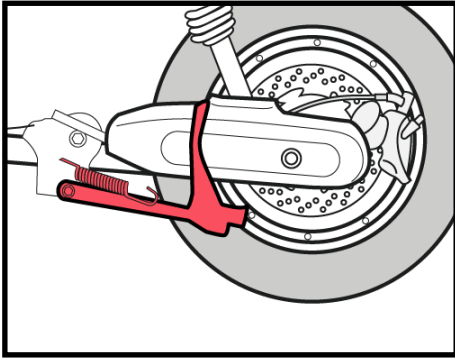

I. Stand on the left side of the bike. The centre stand is under the swing arm.

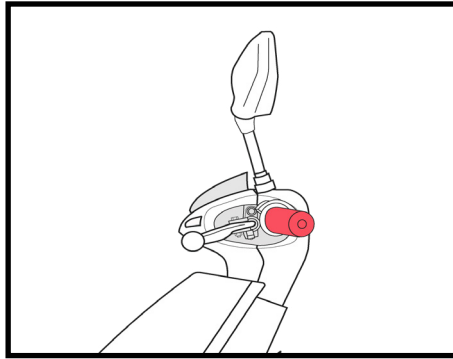

II. Keep your balance, grab the handlebar.

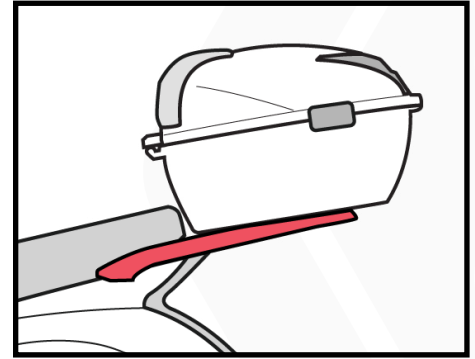

III. And grab the rear rack at the same time.

# Operation Guide

## 10. Stand

### b. Centre Stand

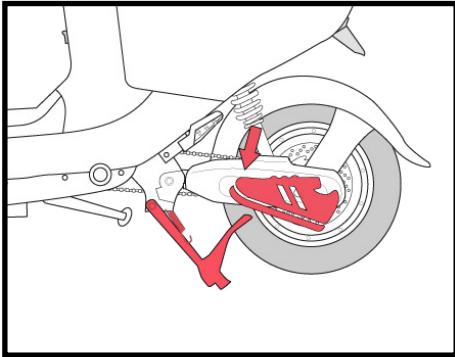

IV. Step on the centre stand peg firmly with your right foot.

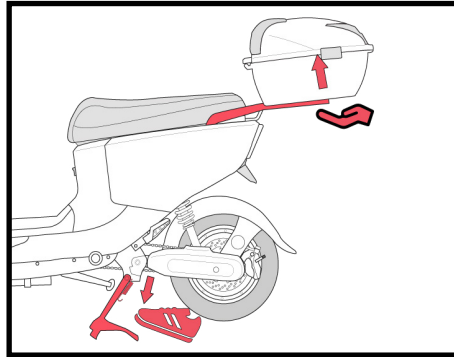

V. While keeping your balance, step down on the peg firmly and lift the rear rack up.

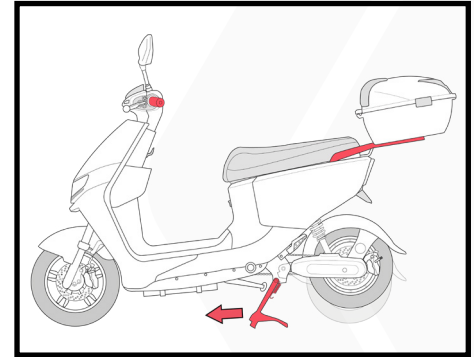

VI. To get the bike off the centre stand, put your right foot in front of the centre stand and gently push the bike forward.

# Operation Guide

## 10. Stand

### b. Centre Stand

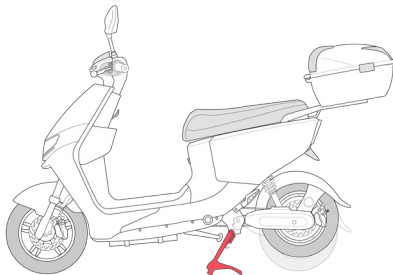

#### **WARNING:**

- Both side kickstand and centre stand should be kicked up before you ride the bike.
- Be careful when using the centre stand. If you find it difficult to use the centre stand, visit your EMMO dealer for a more detailed demonstration on how to use the centre stand.

#### **NOTICE:**

- Keep your balance when trying to put the bike on the centre stand.
- Keep the bike in the upright position at all times. **DO NOT** lean the bike towards either side.

# Operation Guide

## 11. Pedal

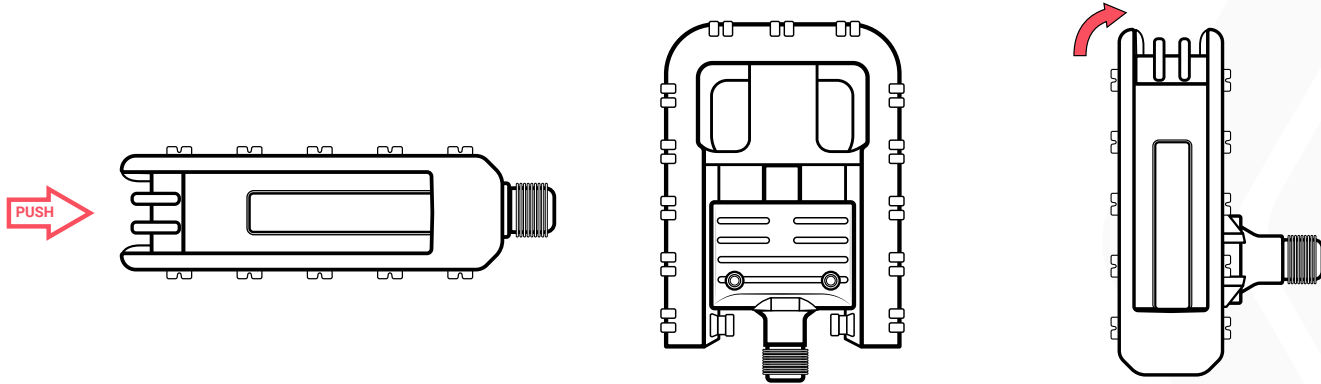

### How to fold the pedals:

- Push the pedal from the side (as shown).
- Fold the pedal up while you continue pushing from the side.

# Operation Guide

## 11. Pedal

### a. Headlight

The headlight assembly has multiple operation modes - high beam, low beam and daytime running light, to accommodate your needs under different conditions.

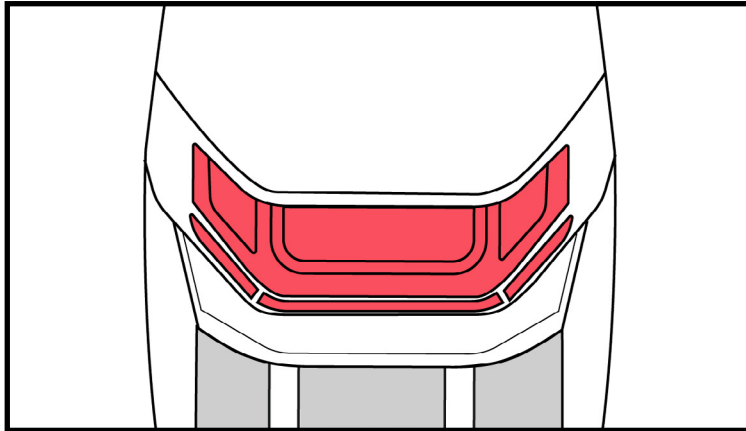

# Operation Guide

## 12. Lights

### b. Tail light & Brake Light

The tail light increases your visibility to others at night/under dark conditions. The brake light signals to the traffic behind you that your E-bike is slowing down so that they can adjust their speed accordingly.

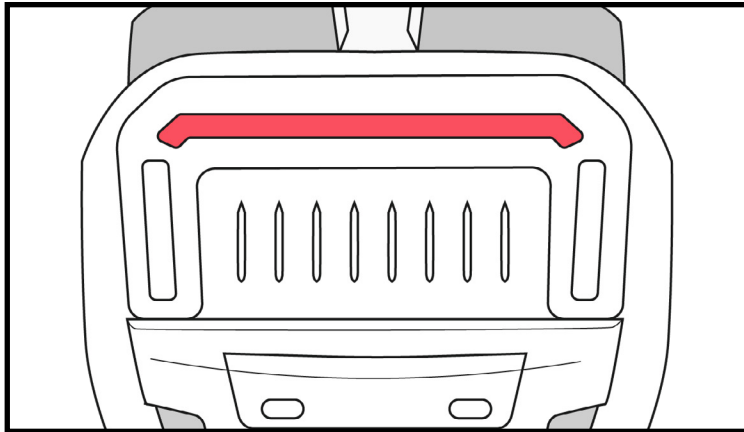

# Operation Guide

## 12. Lights

### c. Signal Lights

The built-in turning signals give the nearby traffic a better insight of your intended route.

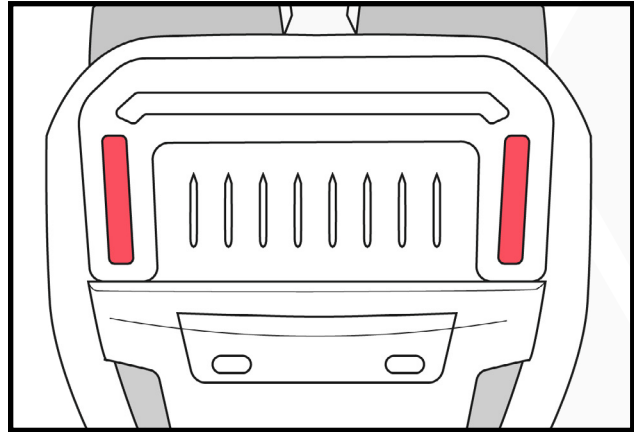
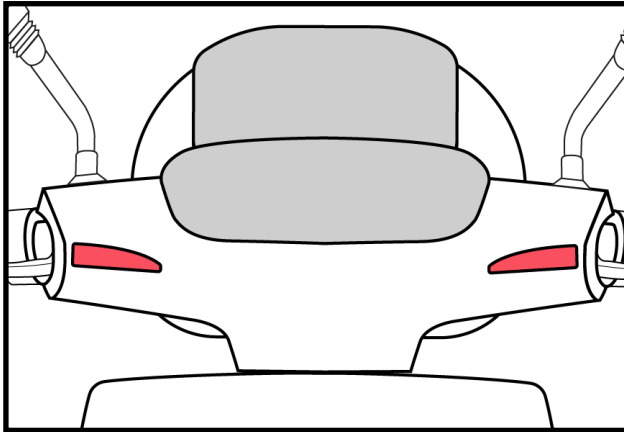

# Operation Guide

## 13. Cleaning / Lubricating the Chain

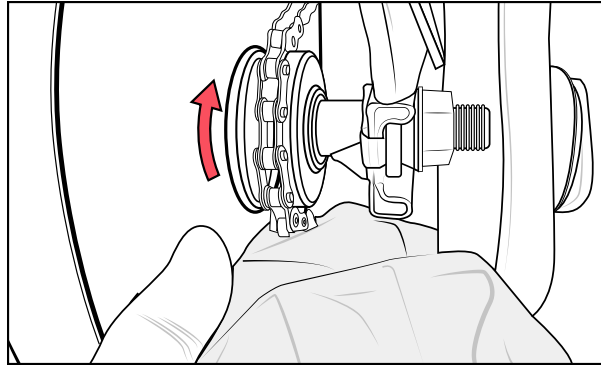

### How to Clean the Chain:

- Put the bike on the service stand lean the bike on the stand.
- Locate the chain on the right side of the bike, near the rear wheel hub.
- Hold a clean cloth to the chain (as showed).
- Turn the pedal to clean the chain.
- Apply new bicycle chain oil to the sprocket and chain.

# Operation Guide

## 14. Tire Pressure

It is recommended to check the tire pressure on a regular basis to keep things at their best working conditions.

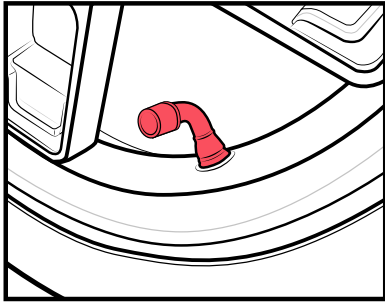

I. Locate the valve on the rim.

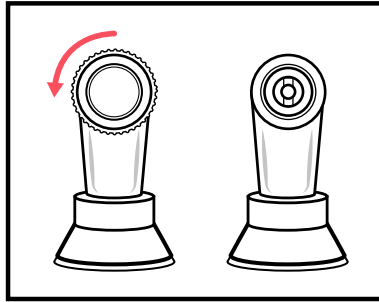

II. Remove the valve cap.

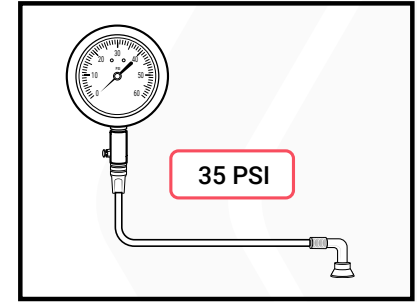

III. Use an air pump with gauge to adjust the tire pressure to 35 PSI.

### Tire pressure affects the following:

- Service life of the tires and other components of the bike.
- Riding safety.

# Operation Guide

## 14. Tire Pressure

- Riding comfort
- Travel distance



### **WARNING:**

- You **MUST** inflate the tire to the recommended tire pressure before the first ride. Failure to do so may damage your bike and void your warranty.
- **DO NOT** over-inflate, as this could damage the tire or wheel. (a recommended tire pressure range is marked on both tires by the manufacturer)

# Operation Guide

## 15. Serial Number

### a. Frame Number

Locate the VIN cover in the panel facing driver.

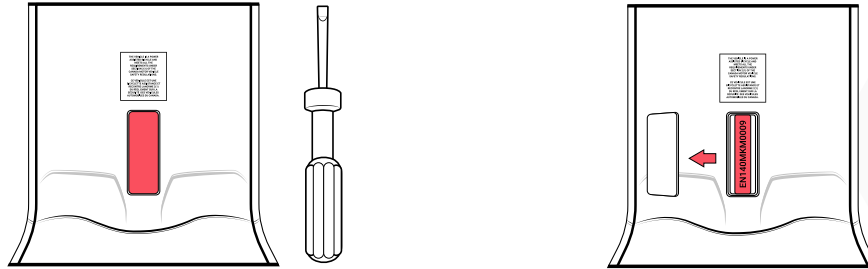

#### Find the Frame Number:

- Use a flat head screwdriver to remove the VIN cover.
- You will find the Frame Number engraved on the frame.
- Put the VIN cover back.

# Operation Guide

## 15. Serial Number

### b. Motor Number

Located on the motor.

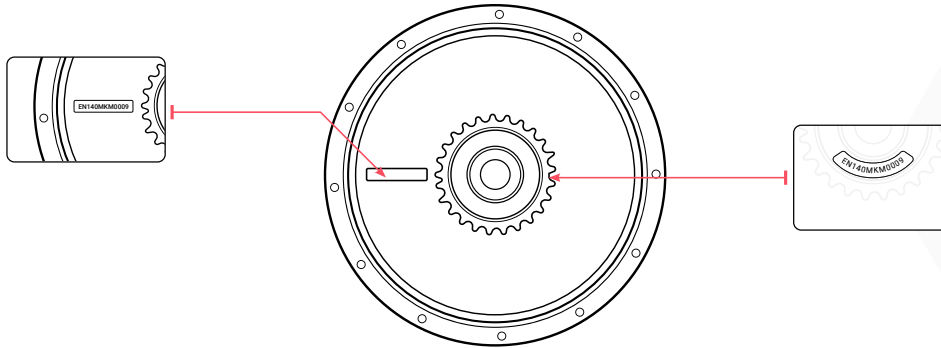

**The motor number could be located at the following locations:**

- **Location 1:** On the motor cover plate.
- **Location 2:** Behind the sprocket on the motor.

# Riding Guide

## 1. Checking List Before Riding

- Whether the handlebar is stable and flexible when turning.
- Whether the right and left switches on the handlebar can work properly or not.
- Whether the throttle can work properly or not.
- Make sure the tires are inflated to the recommended tire pressure (35 PSI).
- Check tire surface, make sure there are no cracks, damages, and foreign matter punctures or attachments.
- Check whether the tread depth is enough, for your safety, tires should be replaced when the tread depth is below the recommended value by the manufacturer.
- Whether any error warning light are on the speedometer.
- Whether the battery capacity is enough for your trip.
- Whether all lights work properly or not.
- Whether the horn works properly or not.
- Whether the mirrors are clean and adjusted to the appropriate angle.
- Whether the brake oil is enough.
- Whether the brake lever and brake system work properly or not.

# Warranty Policy

**By purchasing any Emmo Inc products or other brand items sold by Emmo Inc, the customer agrees to the policies and procedures outlined below.**

Terms and conditions apply for eligibility of warranty. Please refer to [Terms and Conditions](#).

Any warranty is extended to the original owner with the original purchase paperwork. This portion does not cover the purchase of parts or the purchase of products sold by Emmo Inc that is not an electric bike, electric scooter ebike, electric motorcycle style ebike, electric mobility scooter, kick-style electric scooter, or ride-on toy.

## **Electric Scooter E-Bike**

Emmo dealers may charge an assembly fee to assemble the ebike.

- Comprehensive One Year Warranty(up to 6000km) Two year manufacturer warranty on the frame. One year repair or part replacement is extended to the original owner on the swing-arm, motor, and controller against manufacturer's defect in workmanship and materials on all e-bikes, mobility scooters.
- Manufacturer's comprehensive warranty does not cover such parts including, but not limited to: seats, plastic housings and shrouds, pitting, scratches and chips, brake pads, tires, tubes, or damage due to lack of maintenance, accident, misuse or abuse. Damage incurred from water, road salt and other foreign debris or chemicals are not covered by the comprehensive warranty. The labour of any warranty repair will be covered by the original store that the Electric Bike was purchased from only when it is being repaired at said store. The parts will be covered by Emmo Inc. You are responsible for providing original purchase paperwork and shipping the item to and from the store.

- Six Month Warranty Six month warranty on original Batteries and Chargers provided that they have been maintained as instructed by your vehicle hand-book and not subjected to freezing temperatures. For Lithium models, the chargers must match the lithium batteries. Emmo is not responsible for any damage resulting in using another brand or voltage of charger. The customer is responsible for providing original purchase paperwork and shipping the item to and from the store.
- If you are not able to bring the ebike to the location you purchased from, you may be required to ship the item and a copy of your purchase paperwork to Emmo Inc before receiving a replacement item. You are responsible for shipping to Emmo Inc. Once the warranty claim is approved, Emmo Inc will arrange the shipping for the replacement parts and cover the return shipping to you unless expressed otherwise by Emmo Inc. Labor will not be covered by Emmo Inc.
- Certain conditions that may limit or completely void the warranty of your e-bike are: altering the ebike from its original design or its intended use, eg: pulling a trailer, as a delivery vehicle or any commercial use.

## **Purchased Parts**

Please consult your Emmo dealer for more details of the parts policies.

- Shipping Damage: Emmo Inc will not be held responsible for any lost, stolen, or damaged items due to any delivery services or courier actions. Report any damage to Emmo Inc within 7 days of receiving the part with pictures for any shipping damage and proof of purchase. Please note the damage on the shipper's Bill of Delivery prior to signing off on the shipment. Shipping damage is not covered by Emmo Inc if you choose your own shipping method or freight forwarder. The cost of shipping will not be covered under warranty unless Emmo Inc agrees in writing to cover the shipping cost.
- Repair and Store Purchases of Emmo Inc Products: Any warranty is extended to the original owner with the original purchase paperwork. Any return or exchange within 7 days must be in new, unused, and

original packaging. The customer is responsible for notifying Emmo Inc of the return or exchange and the cost of shipping will not be covered under warranty unless Emmo Inc agrees in writing to cover the shipping cost. On all return and exchange items, a restocking fee of 20% will be withheld from the refund amount unless Emmo Inc has agreed to another arrangement in writing. The cost of the item minus the restocking fee will be refunded once the product is returned and determined to be returnable. Restocking fees are 20% of MSRP not including Taxes, Freight/Shipping or PDI. Items out of original packaging will not be accepted.

- **Part Warranty Policy:** All items with warranty must have a valid warranty sticker. For Lithium models, the chargers must match the lithium batteries. Emmo is not responsible for any damage resulting in using another brand or voltage of charger or using an Emmo item with items that are not sold by Emmo Inc. Within 7 days, any items defective by manufacturer quality and are under warranty can be replaced. After 7 days, any items defective in manufacturer quality and are under warranty can be repaired. Warranty does not cover damage due to lack of maintenance, accident, misuse or abuse. Damage incurred from water, road salt and other foreign debris or chemicals. The labour of any warranty repair will be covered by the original store that the Emmo Inc part was purchased from only when it is being repaired at said store. For repairs that are done on items that are not from Emmo Inc, only a 7-day Parts Warranty will be included.
- If the part was paid by financing, you are responsible for any cancellation fees or penalties charged by the third party financing company unless Emmo Inc has agreed to cover the fees in writing. The financing loan agreement will only be cancelled after Emmo Inc has received and approved the returned item.
- For repairs that are done on items that are not from Emmo Inc, only a 7-day Parts Warranty will be included. Emmo Inc is not responsible for items modified from its intended use or purpose resulting in damage to the ebike or injury to the customer or third party.

 **NOTICE:** If you have any questions, please contact your local dealer.

# Leave Us a Review

By sharing your experience with EMMO, you can extend your warranty for an extra **3 months for FREE**.

Your review will help us to continue providing great products and services, and help others understand how EMMO can make their life greener.

Thank you for choosing EMMO.



Scan the QR code to  
leave us a review.

# Contact Us

## LOCATION

### **EMMO Mississauga**

1224 Dundas St E, Unit 6  
Mississauga, ON L4Y 2C5  
Canada

### **EMMO Vaughan**

1750 Steeles Avenue West, Unit 15-17  
Concord, ON L4K 1S6  
Canada

## Contact

Toll Free: +1-888-217-1217

Email: [service@emmo.ca](mailto:service@emmo.ca)

### **EMMO Toronto**

438 Spadina Ave, Unit 2  
Toronto, ON M5T 2G8  
Canada

### **Toronto Service Center**

8 Oxford Street  
Toronto, ON M5T 2G8

## Website

[www.emmo.ca](http://www.emmo.ca)

[www.emmo.ca/pages/contactus](http://www.emmo.ca/pages/contactus)



[WWW.EMMO.CA](http://WWW.EMMO.CA)

